



The World Disability Union (WDU) was established in 2011 as an inclusive umbrella organization for 400 sub-organizations from 91 countries with the status of International Qualified Entities. Within the scope of the Convention on the Rights of Persons with Disabilities guaranteed by countries; Disability prevention; Overcoming the disability; within the framework of the WDU Implementation Projects it developed for the inclusion of people with disabilities into the society, it aims at sustainable corporate work and unity with all relevant and competent parties.

We are the only institution that grants international certificates to places that are environmentally qualified for people with disabilities, whether governmental or private (airports, hotels, transportation, parks, museums, malls....)

The certificate of the WORLD DISABILITY UNION for the places eligible for people with disabilities in its three sections is an official recognition that this place is friendly for people with disabilities **In line with Article 9 of the U N Convention.**



The World disability union continues to evaluate many places eligible for people with disabilities in all countries, around the world, as the committees are working to follow up the audit.

Ministries and Government Departments

Anyone should review government departments that provide public services to the community, as persons with disabilities are an integral part of the fabric of this affluent society, they will go to these departments to receive services or to clear their transactions.

Therefore, the criteria for the advancement and development of societies have been to facilitate access by persons with disabilities to public places, which any person can access, as a natural and necessary right that all institutions must provide to them.

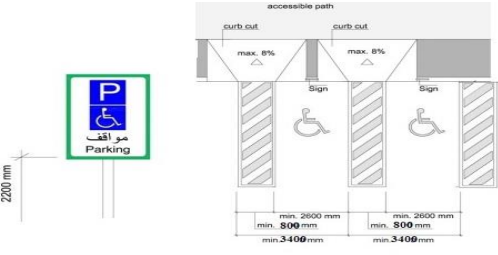
Accordingly, it must fulfill a set of conditions, So that it gives 5 points for each of the conditions necessary to obtain the World Disability Union Certificate, An additional 5 points are awarded for each additional service provided by the department that is not covered by these conditions:

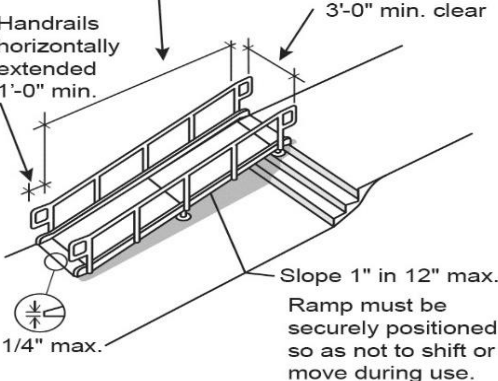
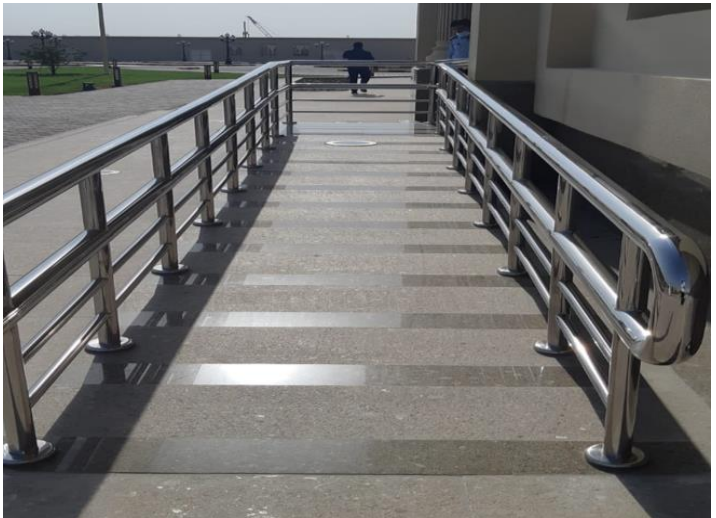
No.	Conditions	design or photo
1.	<p>Car Parking (close, width, covered, number compared to total number of parking places, slope is close)</p>  <p style="text-align: center;">accessible parking places with lateral aisle</p>	
2.	<p>Slopes</p> <p>Max. 30" of rise without intermediate landing.</p> <p>Handrails horizontally extended 1'-0" min.</p> <p>3'-0" min. clear</p>  <p style="text-align: center;">Portable Manufactured Ramp</p>	

3. Entrance (door width & easy of opening)

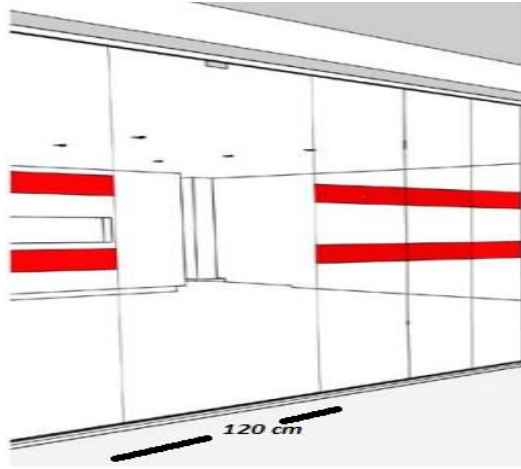

4. The reception (should be of an appropriate height for persons with disabilities or part of it)



5. Reception (height of counter, sign language, braille & indicative lines for the blind)

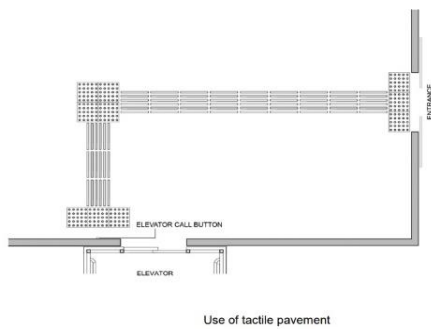

Use of tactile pavement



6. Corridor (width, no barriers to movement)

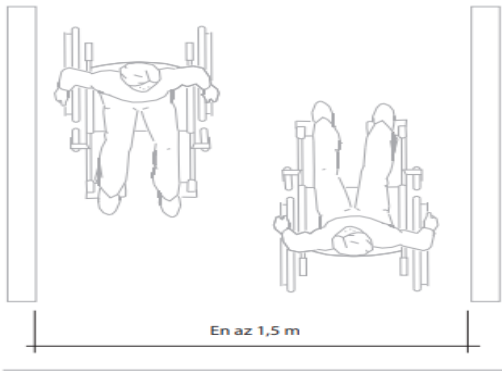
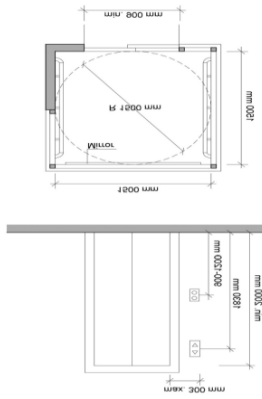

Image 93. Min net width for 2 wheelchairs passage



7. Elevator (Braille or spoken language - width - capacity)

toob dne enoleimtib tohahri tof anoleimhib dnehmrimocoo tof lavayeh



8. Doors (how to open it, wide)



Auxiliary Door at Inaccessible Revolving Door



9. Offices Space (interior spaces)

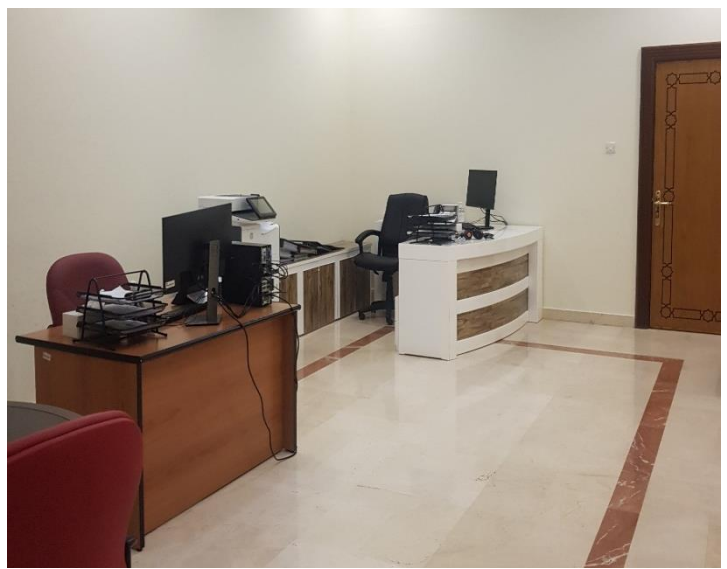
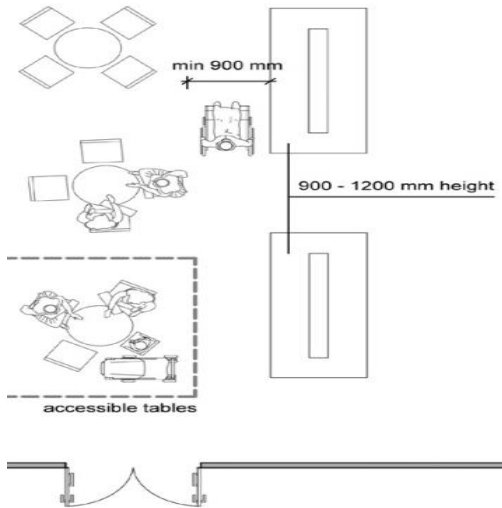

10. Staff culture in dealing with persons with disabilities



11. Braille Signboards

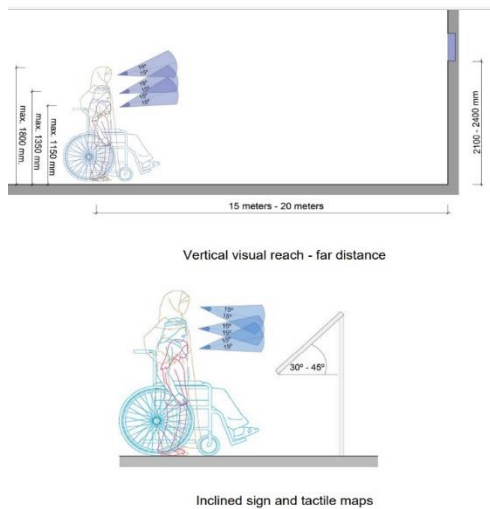

12. Bathrooms

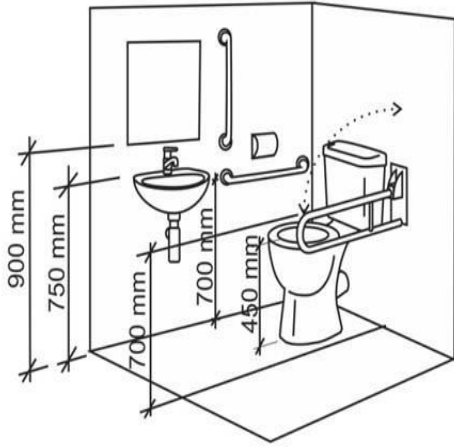

13. The Prayer Room (Ablution Place)



14. The Cafeteria

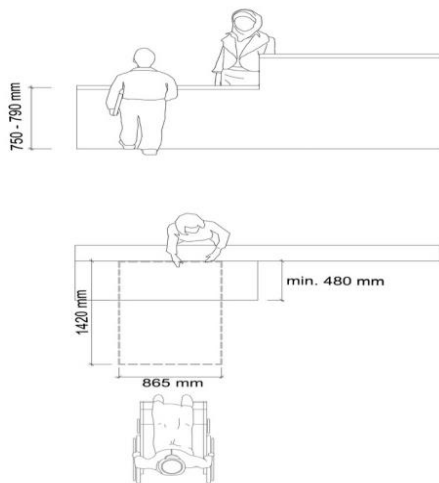

List of Standards for Ministries and Government Departments

No.	Degree Standards	1	2	3	4	5
1.	Parking 10% (maximum 8 parking)					
2.	The slopes are 1m high by 10m long					
3.	Entrances with a width of more than 120cm					
4.	The height of the reception desks is a maximum of 100cm					
5.	Corridor with a width of at least 170cm for a length of more than 10m, and a width of at least 100cm for a length of less than 10m					
6.	<u>The Elevators</u> <ul style="list-style-type: none"> • Door width: not less than 100 cm • The internal space of the elevator: 180cm square • Time period for opening and closing the door: not less than 10 seconds • Button height: No more than 140cm • Voice and Braille 					
7.	The doors are at least 90 cm wide					
8.	Office space suitable for wheelchair movement					
9.	Staff culture in dealing with people with disabilities (attending special courses dealing with people with disabilities + sign language courses)					

10.	Bathrooms are equipped for people with <u>disabilities</u> <ul style="list-style-type: none"> • Width of the door: at least 100cm • The door opens out • Indoor bathroom space: not less than 150cm x 180cm • Sink height: 80 cm • Height of toilet seat: 40cm – 45cm • Height of the auxiliary devices: 60cm – 65cm • Auxiliary Equipment Dimension: Provide 35cm distance on both sides of the toilet chair from the middle of the chair 					
11.	Guide boards in Braille, of appropriate height					
12.	The Prayer Room (Ablution Place)					
13.	The Cafeteria					

* Total Point:

* The Ratio is calculated as follows: $\text{Total Point} / \text{Number of standards} \times 5 \times 100$

* The Ratio: