



**THE UNIVERSAL STANDARDS GUIDE  
FOR PERSONS WITH  
DISABILITIES**



**المقر الرئيسي للاتحاد العالمي للمعاقين**

**W.D.U. SHARJAH U.A.E.**

**SECTION ONE**





# Environmental standards of the World Disability Union

**WDU**  
Physical Disability

<http://worlddisabilityunion.com>



# Car Parking



## Parking 2% (at least 2 parking)

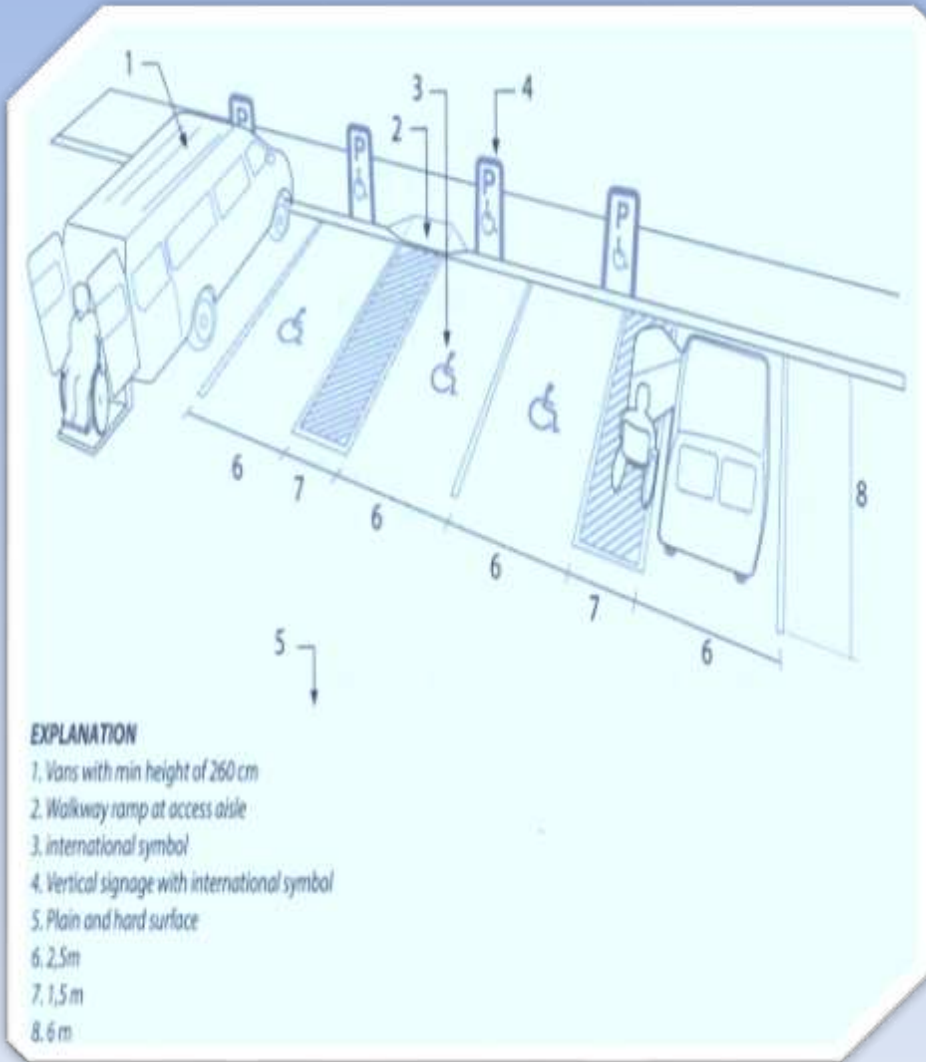
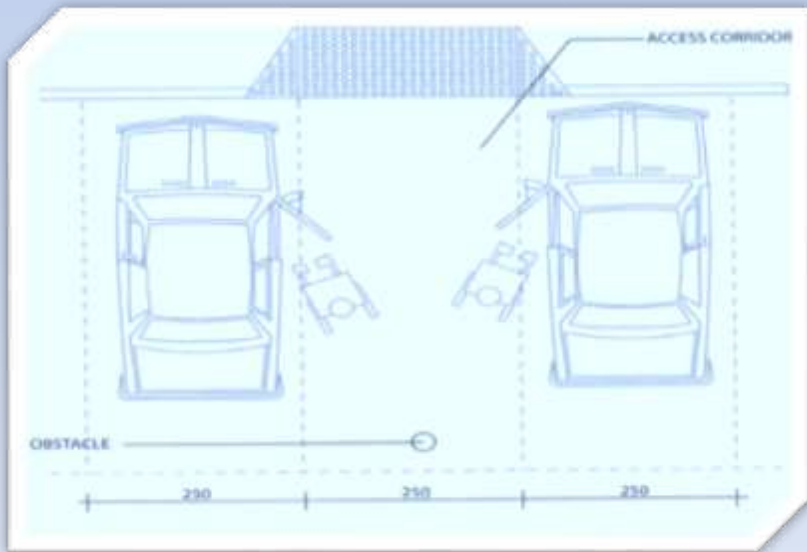
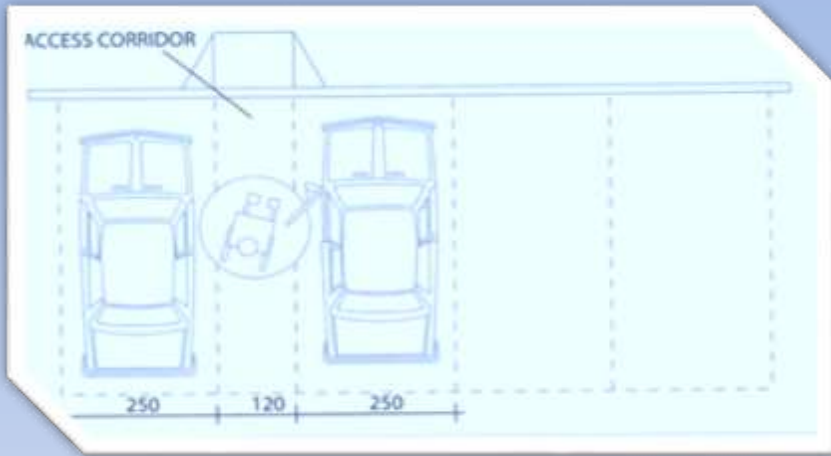



# Parking 2% (at least 2 parking)





# The Ramp from the Car Parking to the Sidewalk

The slopes are 1m high by 10m long

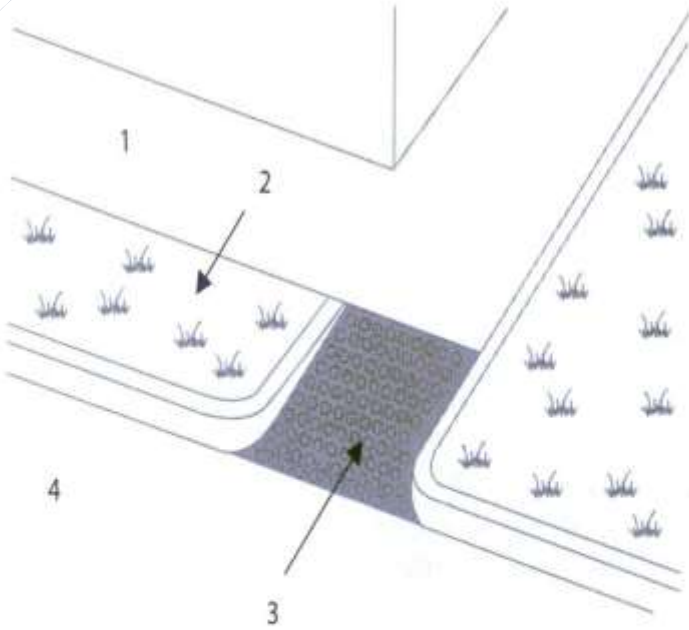

**Explanation**

1. Walkway
2. Surface with the plants or other non-walkable surface
3. Tactile warning surface
4. Vehicle road

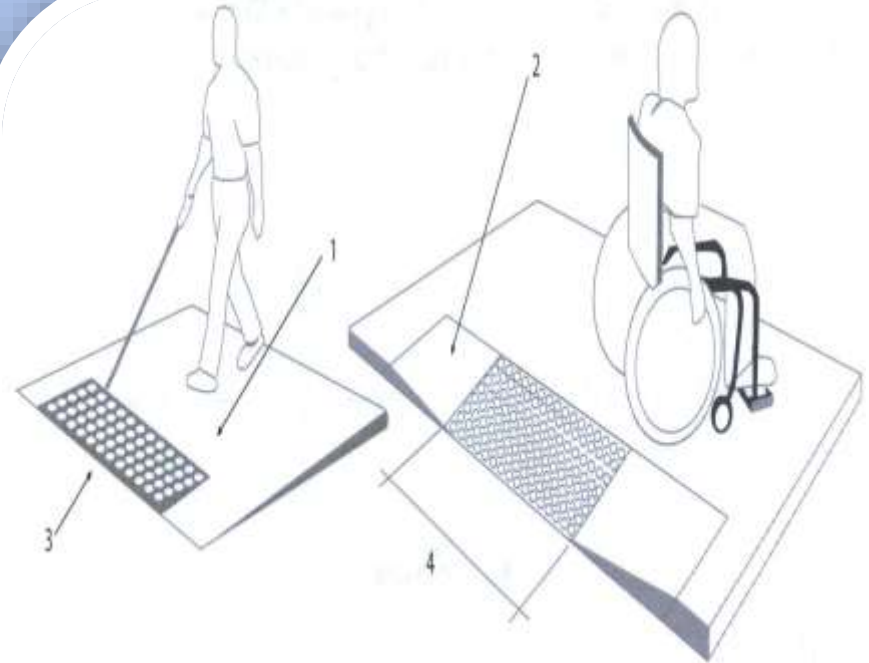

**Explanation**

1. Walkway sloping
2. Walkway with ramps
3. Pavement Ramp with tactile surface on walkway route
4. Min 90 cm



The slopes are 1m high by 10m long







# Entrance Ramp



# The Ramp are 1m high by 10m long

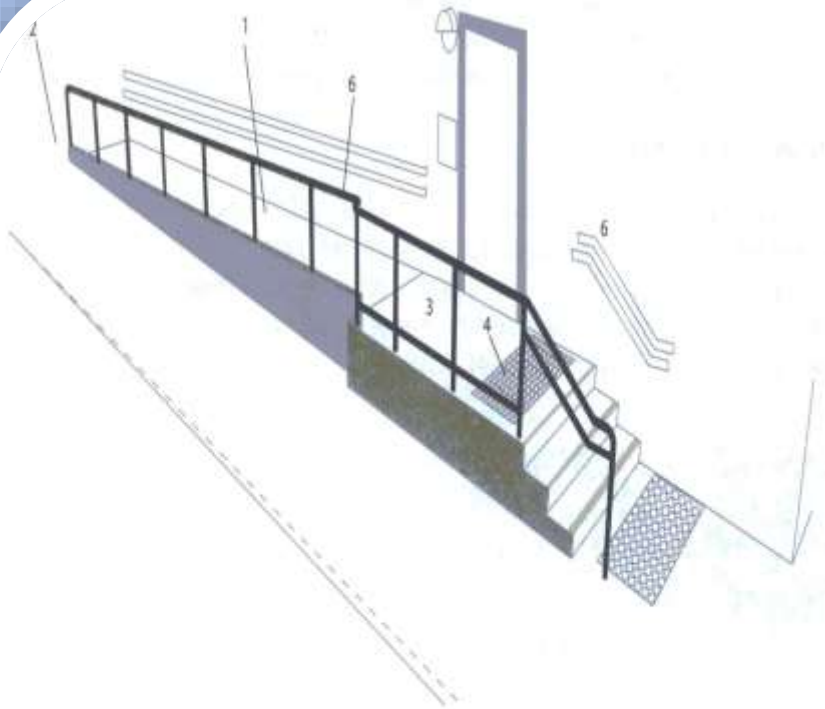

**Explanation**

- 1. Ramp surface, length and slope
- 2. Landing
- 3. Horizontal landing in front of the door at least 150 cm x 150cm
- 4. Tactile warning surface at the beginning and the end of the stairs
- 5. Signed complementary stairs
- 6. Railings on both sides of the ramp and stairs
- 7. Protection border at least 5 cm

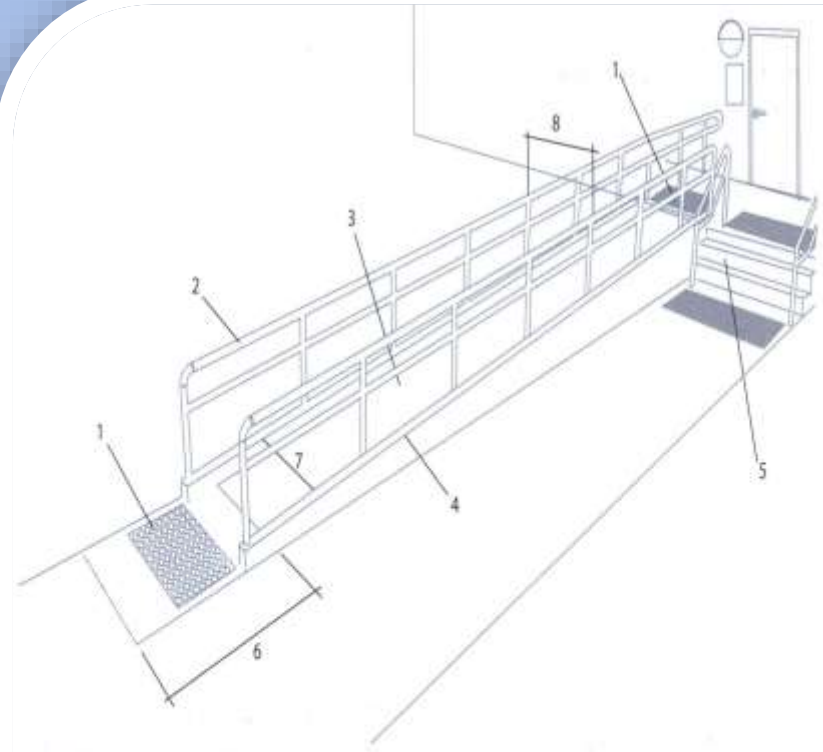

**Explanation**

- 1. Ramp with a tactile warning surface
- 2. Railings on both sides
- 3. 1:20 slope (5 mm on every meter), at most 900 cm length
- 4. Protection border at least 5 cm
- 5. Steps
- 6. Landing at least 150 cm
- 7. Ramp width at least 90 cm
- 8. Distance between railings at least 100 cm



The slopes are 1m high by 10m long





# Entrance Width



# Main entrance with a width of more than 120cm

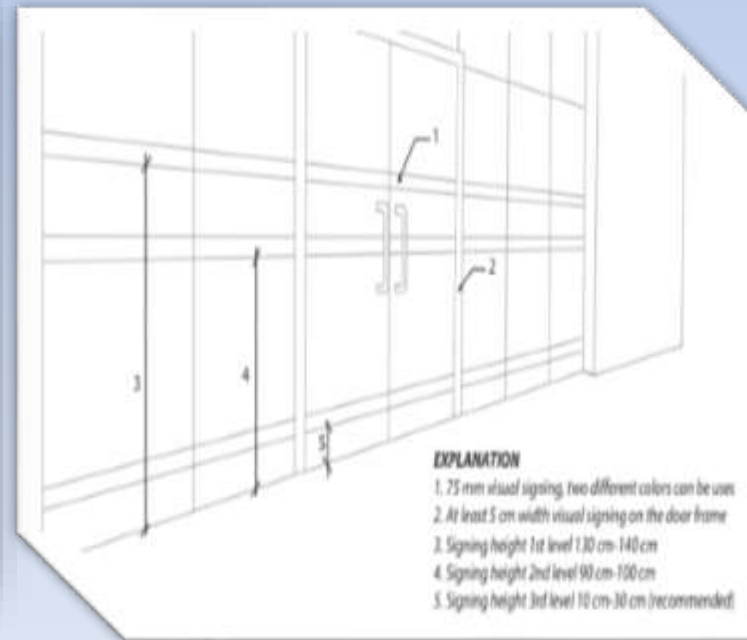
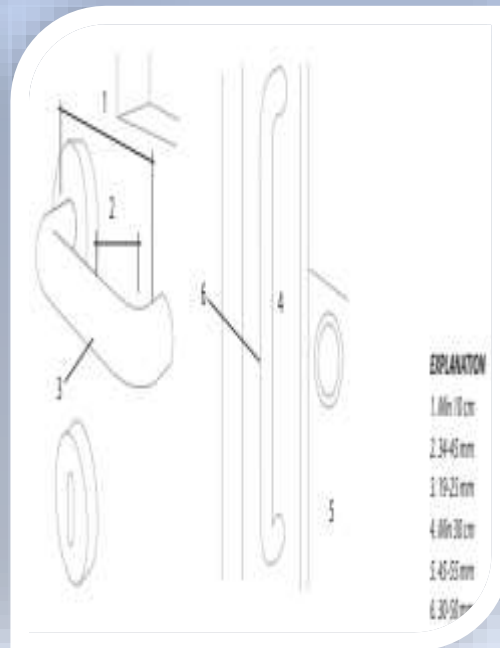
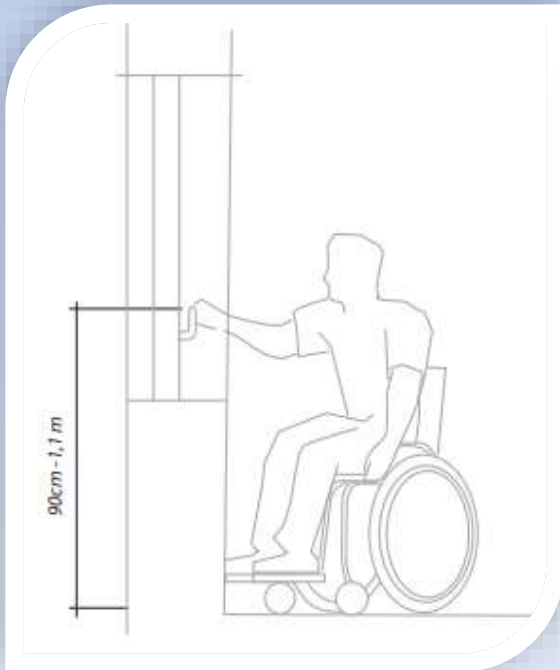
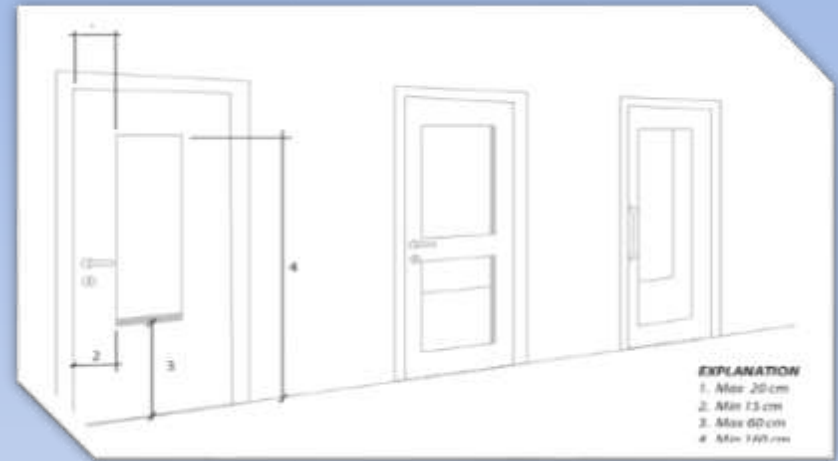
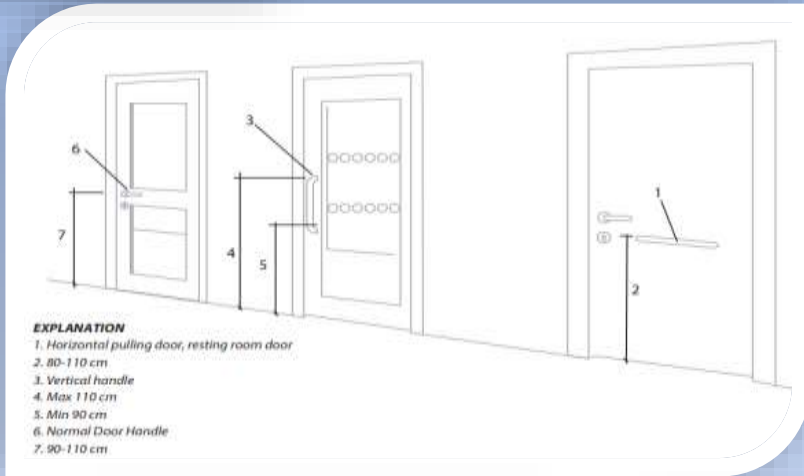



Main entrance with a width of more than 120cm





# The Height of the Reception Counter & the Auditors' Counters

The height of the counters is a maximum of 100cm

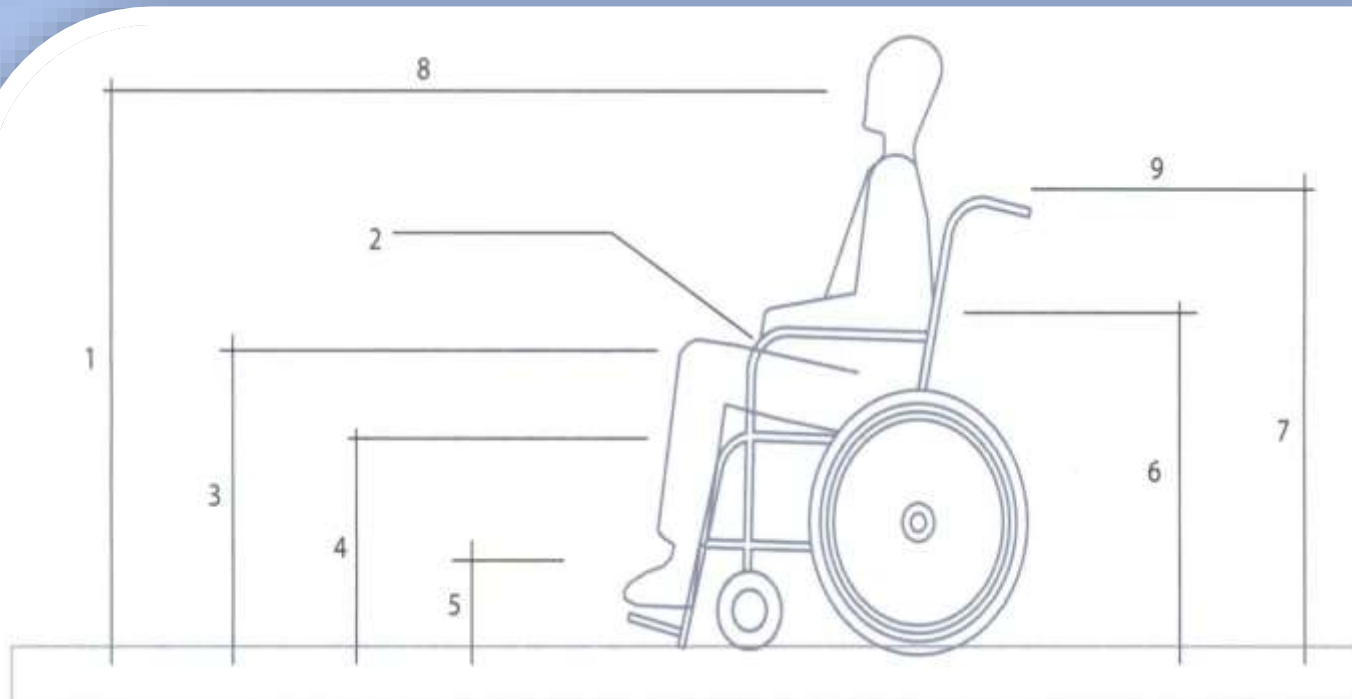

**EXPLANATION**

1- Eye level 1,1-1,3 m

2- Wheelchair arm

3- Knee High 68,5 cm

4- Sitting level 48,5 cm

5- Feet height 20 cm

6- 76 cm

7- Push arm 90 cm

8- Eye level

9- Handle

The height of the counters is a maximum of 100cm





**Waiting Area**



A special place must be available for people with disabilities, especially wheelchair users

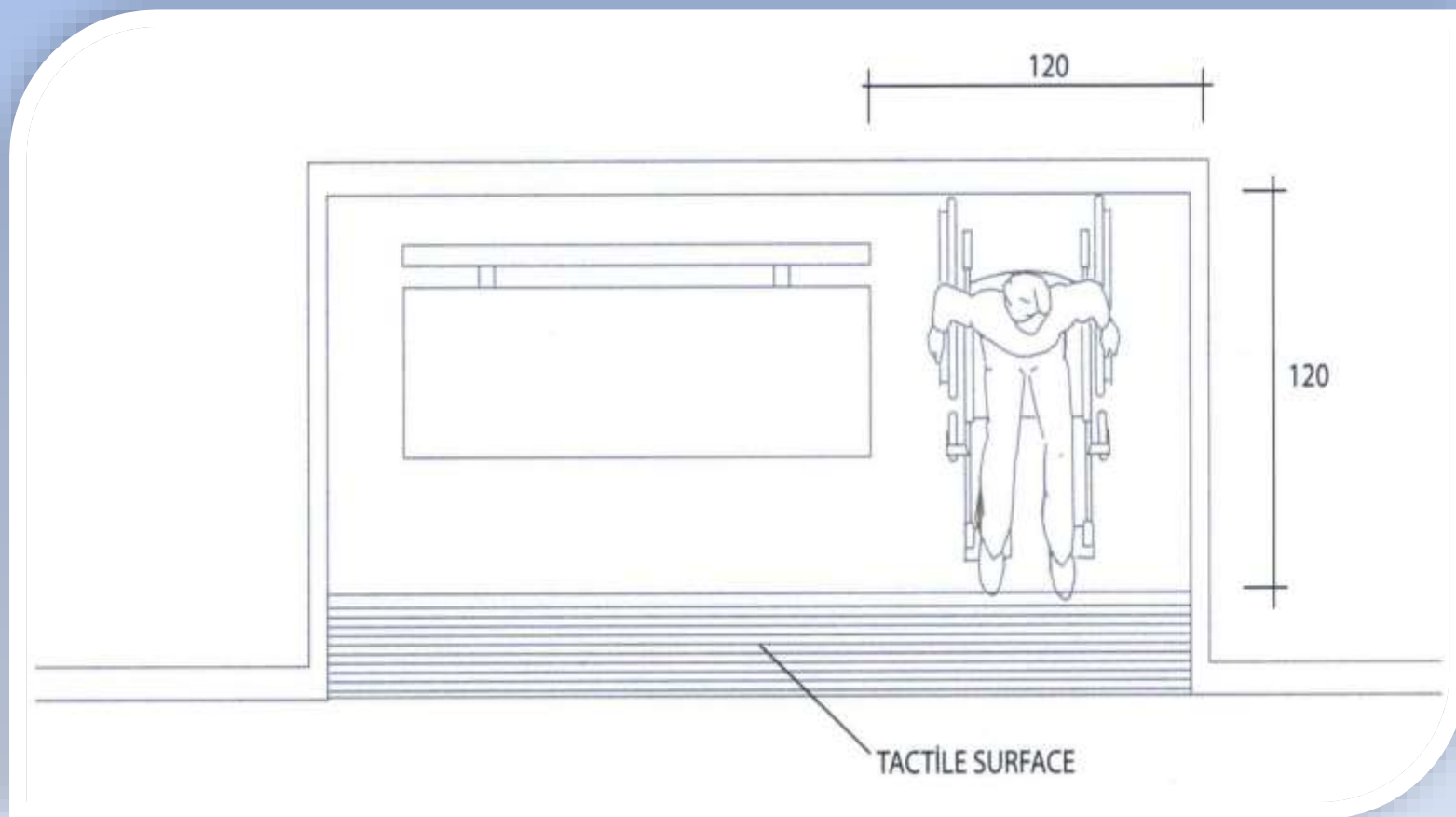

A special place must be available for people with disabilities, especially wheelchair users







# Director Office



There should be no barriers to entry to the office





# Washrooms

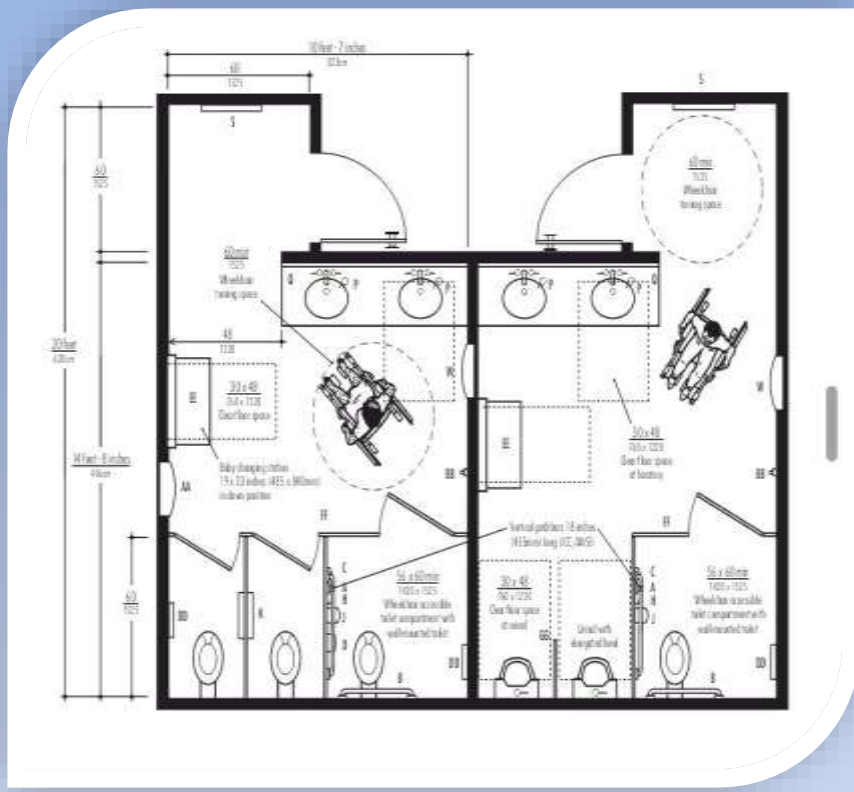
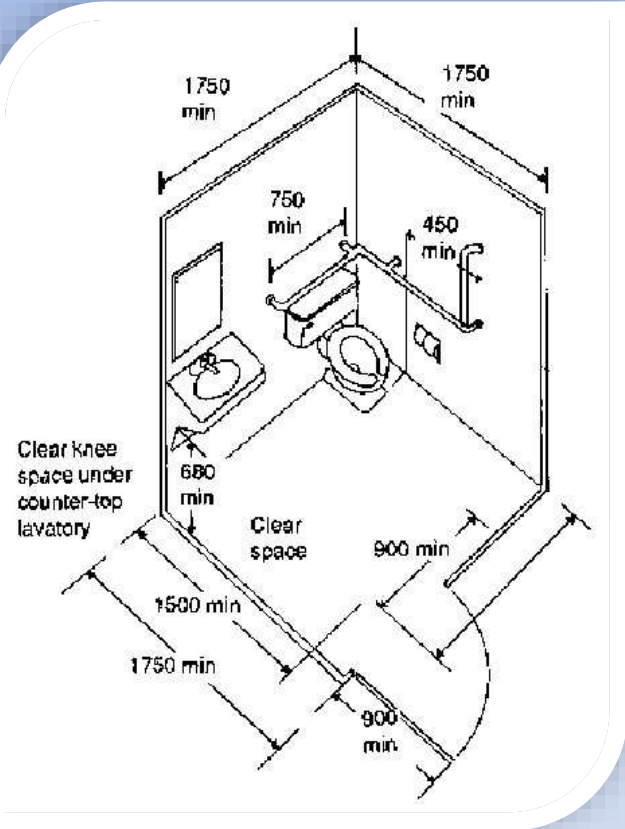

**Bathrooms are equipped for people with disabilities**

**Width of the door: at least 100cm**

**The door opens out**

**Indoor bathroom space: not less than 150cm x 80cm**

**Sink height: 80 cm**

**Height of toilet seat: 40cm – 45cm**

**Height of the auxiliary devices: 60cm – 65cm**

**Auxiliary Equipment Dimension: Provide 35cm distance on both sides of the toilet chair from the middle of the chair**



**Bathrooms are equipped for people with disabilities**  
**Width of the door: at least 100cm**  
**The door opens out**  
**Indoor bathroom space:**

**not less than 150cm x 80cm**

**Sink height: 80 cm**

**Height of toilet seat:**

**40cm – 45cm**

**Height of the auxiliary devices:**

**60cm – 65cm**

**Auxiliary Equipment Dimension:**

**Provide 35cm distance on both sides of the toilet chair from the middle of the chair**





# The Cafeteria



The height of the counters is a maximum of 100cm

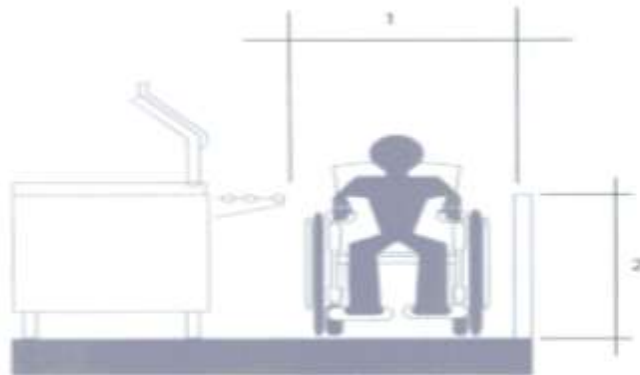

(A)

**Explanation**  
1- Min 90 cm  
2- Max 86 cm

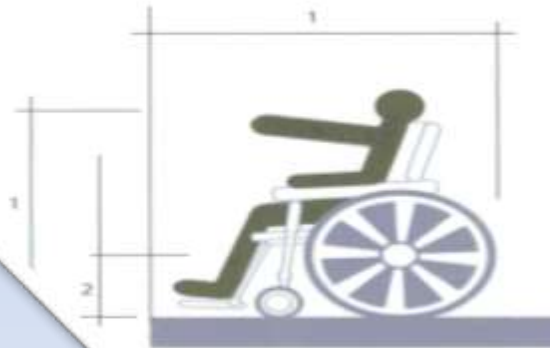

(B)

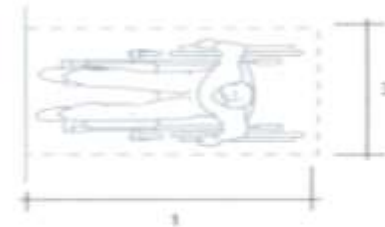

**Explanation**  
1- 122 cm  
2- 38 cm  
3- 76 cm

The height of the counters is maximum of 100cm





# The Elevator

## The Elevator

Door width: not less than 100 cm

The internal space of the elevator: 180cm square

Time period for opening and closing the door: not less than 10 seconds

Button height: No more than 140cm Voice & Braille

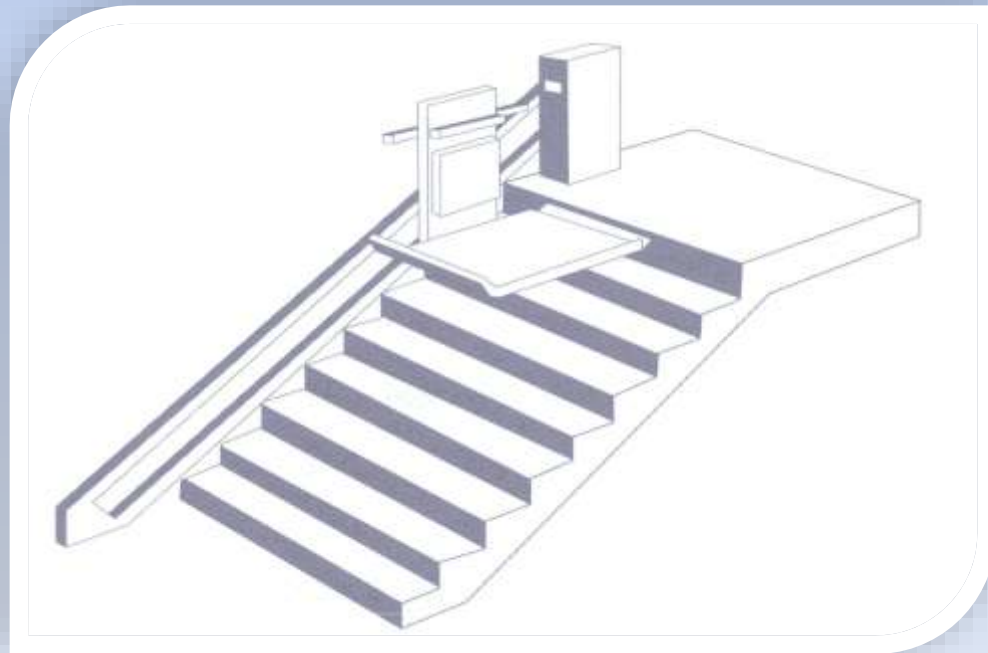



## The Elevator

Door width: not less than 100 cm

The internal space of the elevator: 180cm square

Time period for opening and closing the door: not less than 10 seconds

Button height: No more than 140cm Voice & Braille



# Stairs

## (Handrails on Both Sides)





There must be support on both ends of the stairs and be of non-slip, and the edge of the stairs must have a border and a width of not less than 25cm

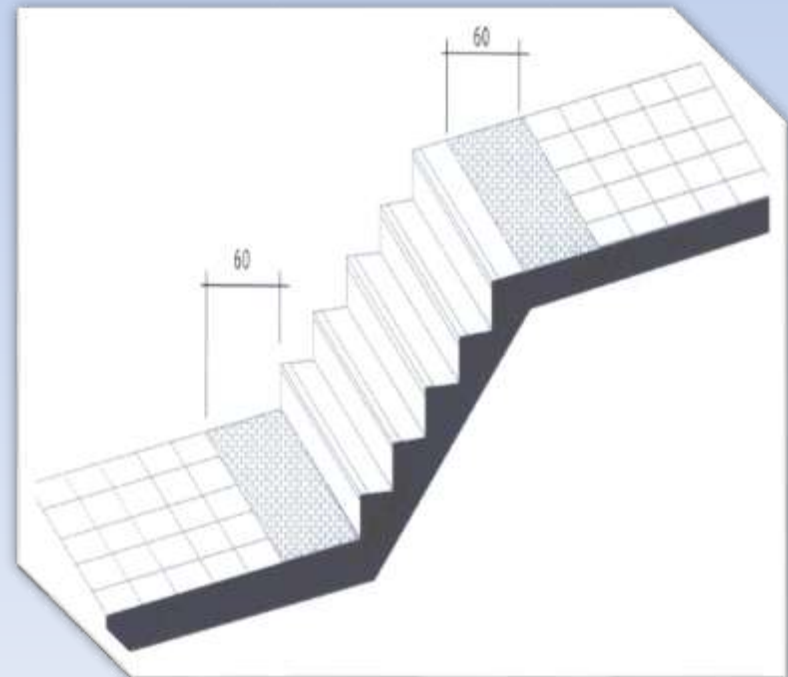
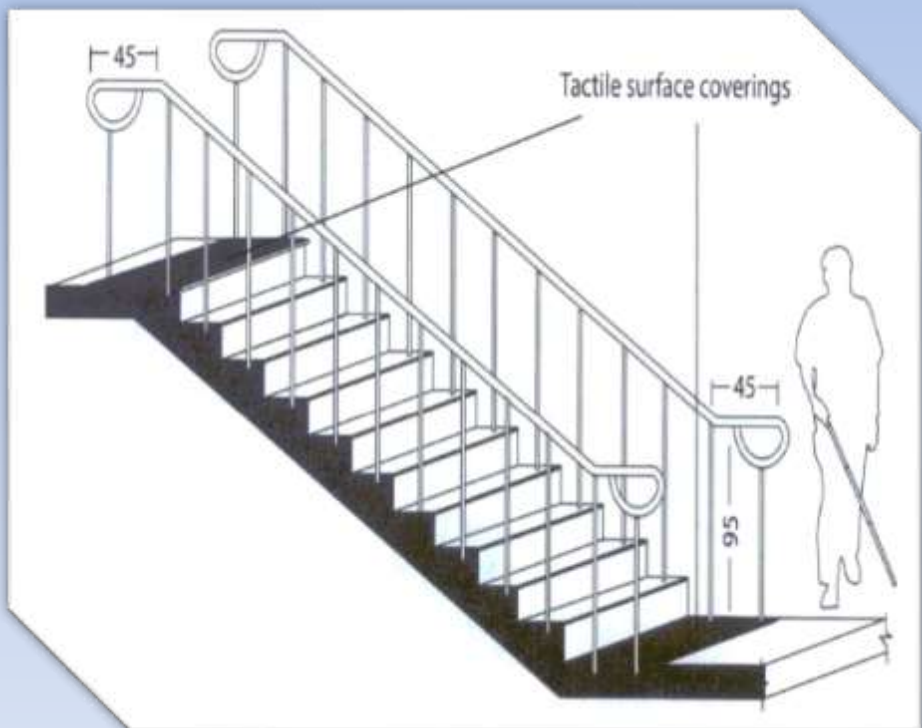



There must be support on both ends of the stairs and be of non-slip, and the edge of the stairs must have a border and a width of not less than 25cm



# Emergency Exits (Ramps – Easy to Open)



The emergency exit should be easy to open from the inside, and there should be guiding panels indicating it





# Detention Rooms



The Detention room must be suitable for people with disabilities and provide all services that are granted to a person without disabilities





# Cars Arrested Transport



## The prisoner's transport vehicle must have an elevator if he has a wheelchair

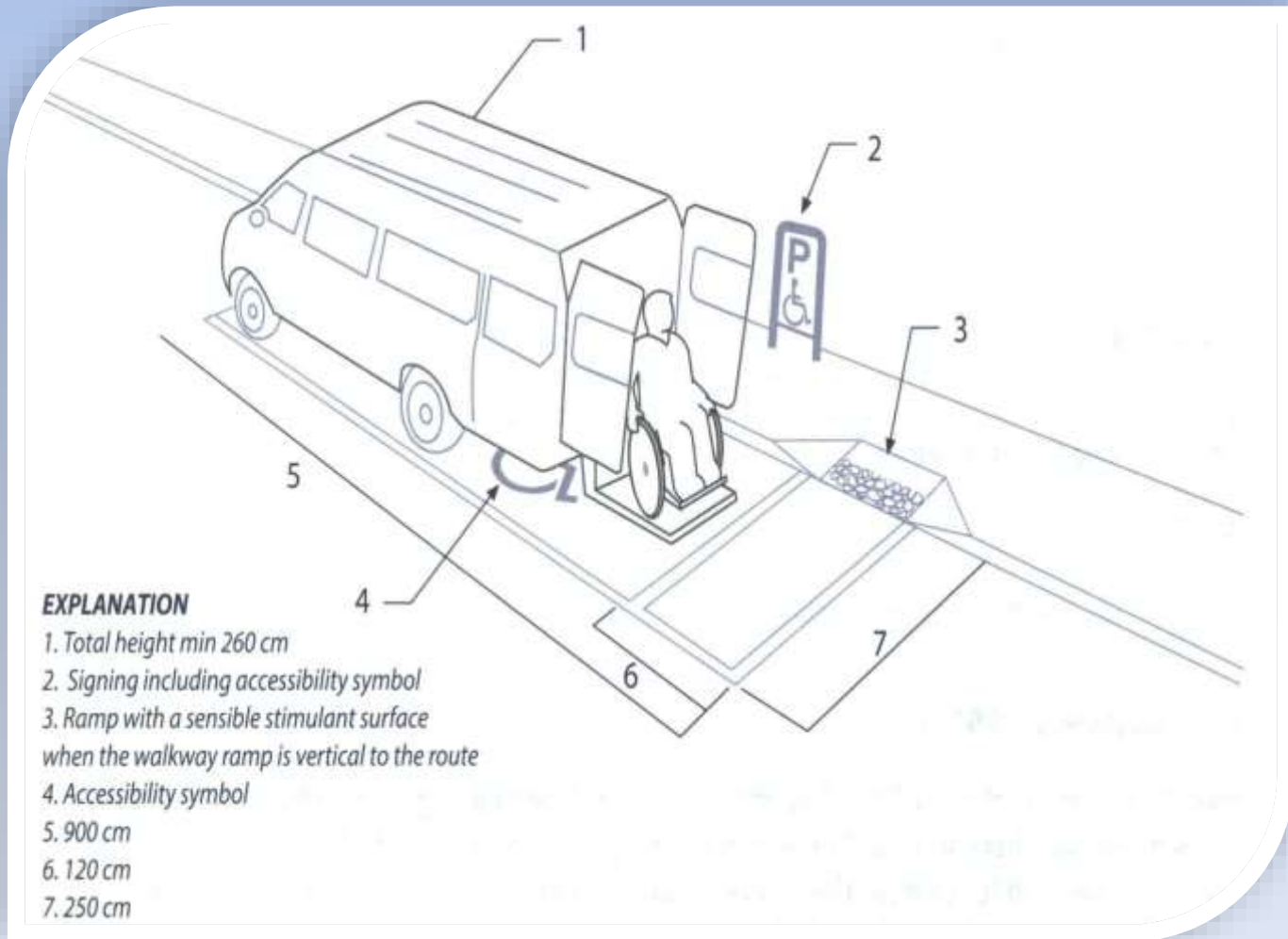



The prisoner's transport vehicle must have an elevator if he has a wheelchair





# Availability of Blind Points (Tack Tail)



# Availability of Tack Tail helps you to obtain the certificate WDU for All Disabilities







# Availability of Tack Tail helps you to obtain the certificate WDU for All Disabilities



# Alarm Bell Lighting Sound



Alarm bells: An alarm bell must be provided inside the bathrooms, as well as an alarm bell with sound and lighting

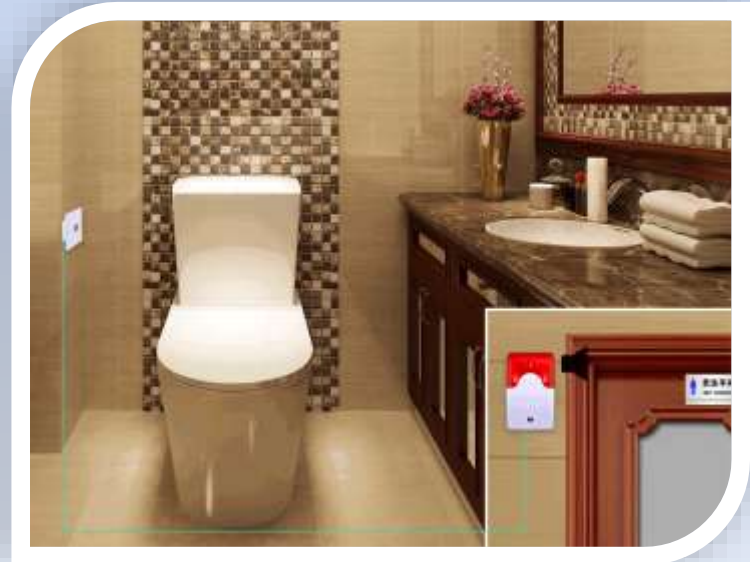
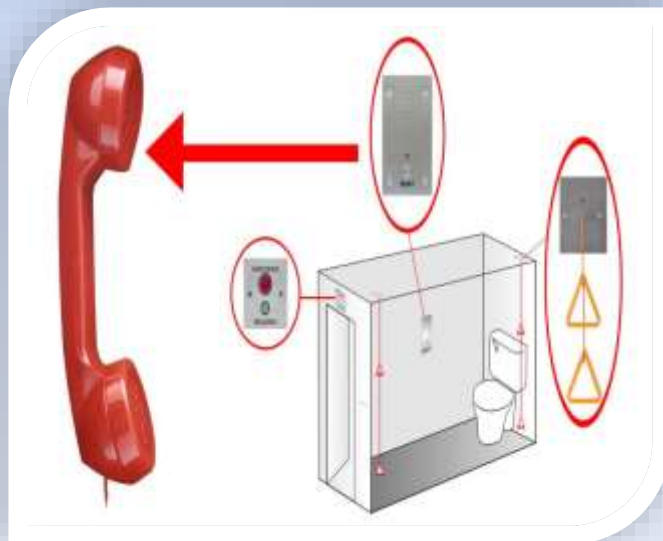





# Staff Culture (Sign Language Courses)



# Courses on how to deal with people with disabilities - sign language





# Types of Certificate



## Physical Disability

Gold 91 – 100 %

Silver 81 – 90 %

Bronze 70 – 80 %





All Disability

Gold 91 – 100 %

Silver 81 – 90 %

Bronze 70 – 80 %





# Evaluation Request Form



# Evaluation Request Form

**M/s. World Disability Union**

**We kindly ask you to send your assessment committee to assess the environmental facilities for people with disabilities in our building.**

**Organization Name:** -----

**Type of Organization:**  Government  Semi-Governmental  Private

**Building type:** -----

**Address:** -----

**Tell Number:** -----

**Email:** -----

\*\*\*\*\*

**Applicant Name:** -----

**Occupation:** -----

**Mobile Number:** -----

**Signature:** -----

**Stamp:** -----

**Web:** <http://www.worlddisabilityunion.com>

**Email:** [shjheadoffice@worlddisabilityunion.com](mailto:shjheadoffice@worlddisabilityunion.com)

**Tell :** 065227212





**In The End**

**I thank you for attending and welcome any inquiries. You can visit our website <http://worlddisabilityunion.com>**

**call : 065227212**

**Email: [info@worlddisabilityunion.com](mailto:info@worlddisabilityunion.com)**